

## Thermal Conductivity Gauge

The XEN-3880-RW thermal conductivity gauge measures thermal conductivity of the surrounding gas. Operating on the principle that gases differ in their thermal conductivity, it can be used to measure gas concentration in binary mixtures or quasi-binary mixtures where component gases have different thermal conductivity. It can also be used to measure pressure in vacuum systems.

The sensor chip consists of a silicon frame with a silicon-nitride membrane. In the center is a heater, with a thermopile measuring its temperature. The chip measures the thermal conductance between the ambient and the center of the membrane. A silicon cover (Roof) on top of the membrane and a welded cap with filter (W) suppress flow sensitivity.

### Features

- Long-term stable analysis of gases in binary and quasi-binary mixtures
- High sensitivity and resolution
- Operating temperature: -250 °C to 150 °C
- Humidity: 0 to 95% RH, non-condensing
- Negligible flow sensitivity

### Technical Specification

Ambient temperature 22 °C and 1 V power supply

#### Dimensions

size naked die (mm <sup>3</sup> )	2.50 x 3.33 x 0.3
Size TO-5 header (mm <sup>2</sup> )	9 Φ x 6
Length pins (mm)	13.5
weight on TO-5 (g)	0.71
weight on TO-5 + cap + filter (g)	1.05

#### Output

in vacuum at < 1 mPa (V/W)	130
in air at 100 kPa (V/W)	30
in air at 10 MPa (V/W)	26
in helium at 100 kPa (V/W)	7
in helium at 10 MPa (V/W)	6.9

#### Time constant

in air (ms)	9
in vacuum (ms)	36

#### Stability

short term, 1 day (ppm)	1
long term, 1 year (ppm)	300

#### Thermal resistance

membrane (kK/W)	100
membrane + air (kK/W)	23

#### Maximum heating voltage

in air (V)	2.5
in vacuum (V)	1

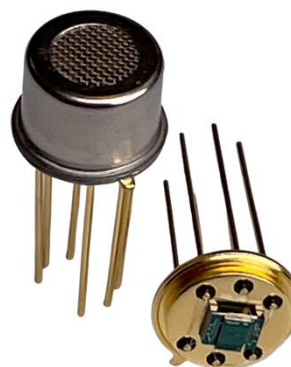

### Some Applications

- Hydrogen, helium and natural gas measurement
- Testing of hydrogen systems with helium
- Vacuum measurement in packages & vacuum systems
- Gas concentration measurement

### Principle of operation

The XEN-3880 performs a measurement of the thermal resistance between the hot junctions of its thermopile in the center of the membrane and the cold junctions on the frame of the chip. This is achieved by heating the center of the membrane using the heater resistor. The resulting temperature increase of the center is measured by the thermopile. The actual temperature increase depends upon the effective thermal resistance between membrane center and ambient, this is influenced by the thermal resistance of the ambient gases.

### Housing

The XEN-3880-RW is mounted on a 6 pin TO-5.

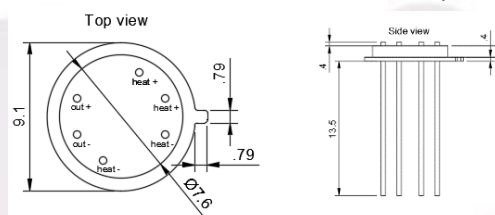

*Whilst RS Product Solutions has taken care to ensure the accuracy of the information contained herein it accepts no responsibility for the consequences of any use thereof and also reserves the right to change the specifications of goods without notice. RS Product Solutions accepts no liability beyond set out in its standard conditions of sale in respect of infringement of third party patents arising from the use of RS Product Solutions products in accordance with information contained herein.*